

## Specifications

<b>Maximum Capacity</b>	6 Tons
<b>Maximum Speed</b>	379.5 in/min
<b>Temperature Range</b>	-15° to 140° F (-29° to 60° C)
<b>Construction</b>	Steel trunnion housing, and thin dense nodular chrome plated translating tubes. The translating tubes feature hydraulic cylinder grade wiper seals, and are guided at both ends by polymeric bearings.
<b>Power</b>	Standard brake motors use Class F insulation with Class B rise (1.15 S.F.) All brake motors are totally enclosed, fan cooled. IP66 or wash-down motors are available. Standard brake motors are UL, CSA, or CE marked, depending on voltage. Heidenhain Incremental Motor Encoder option available.
<b>Mounting</b>	Trunnion
<b>Load Screw</b>	1.50 x .474 and 1.50 x 1.00 Ball Screw (models with asterik contain 1.50 x 1.00 Ball Screws.)
<b>Limit Switches</b>	Independently adjustable. Traveling nut style for best repeatability and setting ease. CAM type limits switches are used on Parallel configurations.

# Product Specifications and Dimensions

## SCN06 Series

Series	Model	Capacity (lbs.)	Speed (in/min)	Std. HP	Max Stroke (inches)	Screw Life (million in.)
SCN06	NZH6-0479*	4942	354.9	5	80.0	3.6
	NZH6-0547*	5643	310.8	5	80.0	2.4
	NZH6-0643*	6633	264.4	5	75.0	1.5
	NZH6-0724*	4481	234.8	3	80.0	4.8
	NZH6-0824*	5100	206.3	3	80.0	3.3
	NZH6-0918*	5682	185.2	3	80.0	2.4
	NZ06-0479	6308	168.2	3	77.0	4.0
	NZ06-0547	7204	147.3	3	72.0	2.7
	NZ06-0643	5645	125.3	2	80.0	5.6
	NZ06-0724	6357	111.3	2	77.0	4.0
	NZ06-0824	7235	97.8	2	72.0	2.7
	NZ06-0918	8060	87.8	2	68.0	1.9
	NZ06-1034	6809	77.9	1.5	74.0	3.2
	NZ06-1176	7744	68.5	1.5	69.0	2.2
	NZ06-1411	6194	57.1	1	78.0	4.3
	NZ06-1721	7555	46.8	1	70.0	2.4
	NZ06-2057	9030	39.2	1	64.0	1.4
	NZ06-2522	8304	32.0	0.75	67.0	1.8
	NZ06-2833	9328	28.4	0.75	63.0	1.3
	NZ06-3208	10562	25.1	0.75	59.0	0.9
	NZ06-4107	9015	19.6	0.5	64.0	1.4
	NZ06-4925	10810	16.4	0.5	59	0.8
	NZ06-5889	12926	13.7	0.5	54	0.5
	NZ06-7217	10455	11.2	0.33	60	0.9
	NZ06-7899	11443	10.2	0.33	57	0.7
	NZ06-8117	11759	9.9	0.33	56	0.6
	NZ06-8894	12000	9.1	0.33	54	0.6
	NZ06-9248	12000	8.7	0.33	53	0.6
	NZ06-10114	12000	8.0	0.33	50	0.6
	NZ06-10608	12000	7.6	0.33	49	0.6
	NZ06-10950	12000	7.4	0.33	48	0.6
	NZ06-11816	12000	6.8	0.25	54	0.6
	NZ06-13660	12000	5.9	0.25	50	0.6
NZ06-15812	12000	5.1	0.25	46	0.6	



3 HP Motor shown

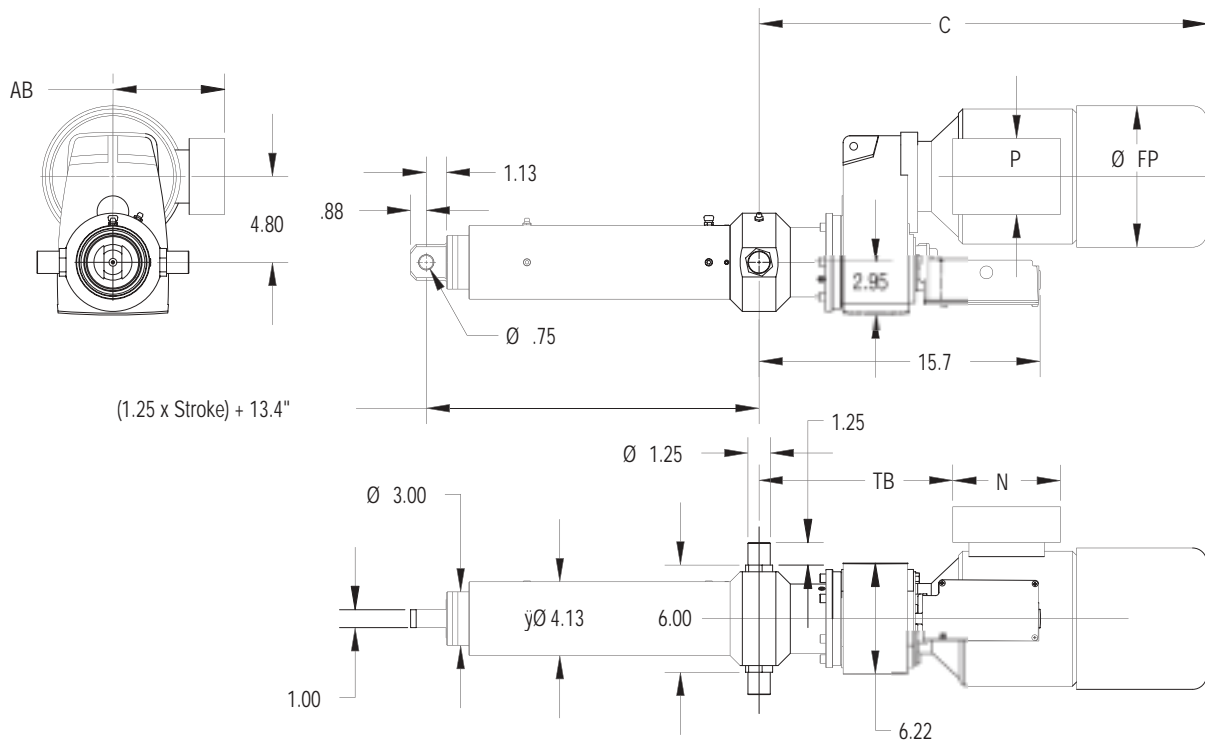

Motor HP	C	FP	AB	TB	N	P
.16 - .25	18.33	5.17	4.84	9.31	5.20	3.43
.33 - .50	20.00	5.71	5.24	10.14	5.20	3.43
.75 - 1.0	21.21	6.50	5.63	10.42	6.02	4.25
1.5 - 2.0	23.25	7.20	5.83	10.61	6.02	4.25
3	25.06	7.91	6.26	10.85	6.02	4.25

Important: See page 9 for mounting position code.



Series	Model	Capacity (lbs.)	Speed (in/min)	Std. HP	Max Stroke (inches)	Screw Life (million in.)
SCN06	NUH6-0448*	2773	379.5	3	80.0	20.3
	NUH6-0568*	3516	299.3	3	80.0	9.9
	NUH6-0670*	4147	253.7	3	80.0	6.1
	NUH6-0831*	3429	204.6	2	80.0	10.7
	NU06-0448	5900	179.9	3	80.0	4.9
	NU06-0568	7480	141.9	3	71.0	2.4
	NU06-0670	8824	120.3	3	65.0	1.5
	NU06-0831	7296	97.0	2	72.0	2.6
	NU06-0980	8604	82.2	2	66.0	1.6
	NU06-1138	9992	70.8	2	61.0	1.0
	NU06-1411	9291	57.1	1.5	63.0	1.3
	NU06-1667	7318	48.3	1	71.0	2.6
	NU06-2018	8859	39.9	1	65.0	1.5
	NU06-2138	9386	37.7	1	63.0	1.2
	NU06-2245	9855	35.9	1	62.0	1.1
	NU06-2371	7806	34.0	0.75	69.0	2.1
	NU06-2588	8521	31.1	0.75	66.0	1.6
	NU06-2870	9449	28.1	0.75	63.0	1.2
	NU06-3193	10513	25.2	0.75	60.0	0.9
	NU06-3777	8290	21.3	0.5	67.0	1.8
	NU06-4202	9223	19.2	0.5	64.0	1.3
	NU06-4485	9844	18.0	0.5	62	1.1
	NU06-5297	11627	15.2	0.5	57	0.6
	NU06-6412	9289	12.6	0.33	63	1.3
	NU06-6589	9545	12.2	0.33	63	1.2
	NU06-7976	11555	10.1	0.33	57	0.7
	NU06-8874	12000	9.1	0.33	54	0.6
	NU06-10088	12000	8.0	0.33	50	0.6
	NU06-11223	12000	7.2	0.33	48	0.6

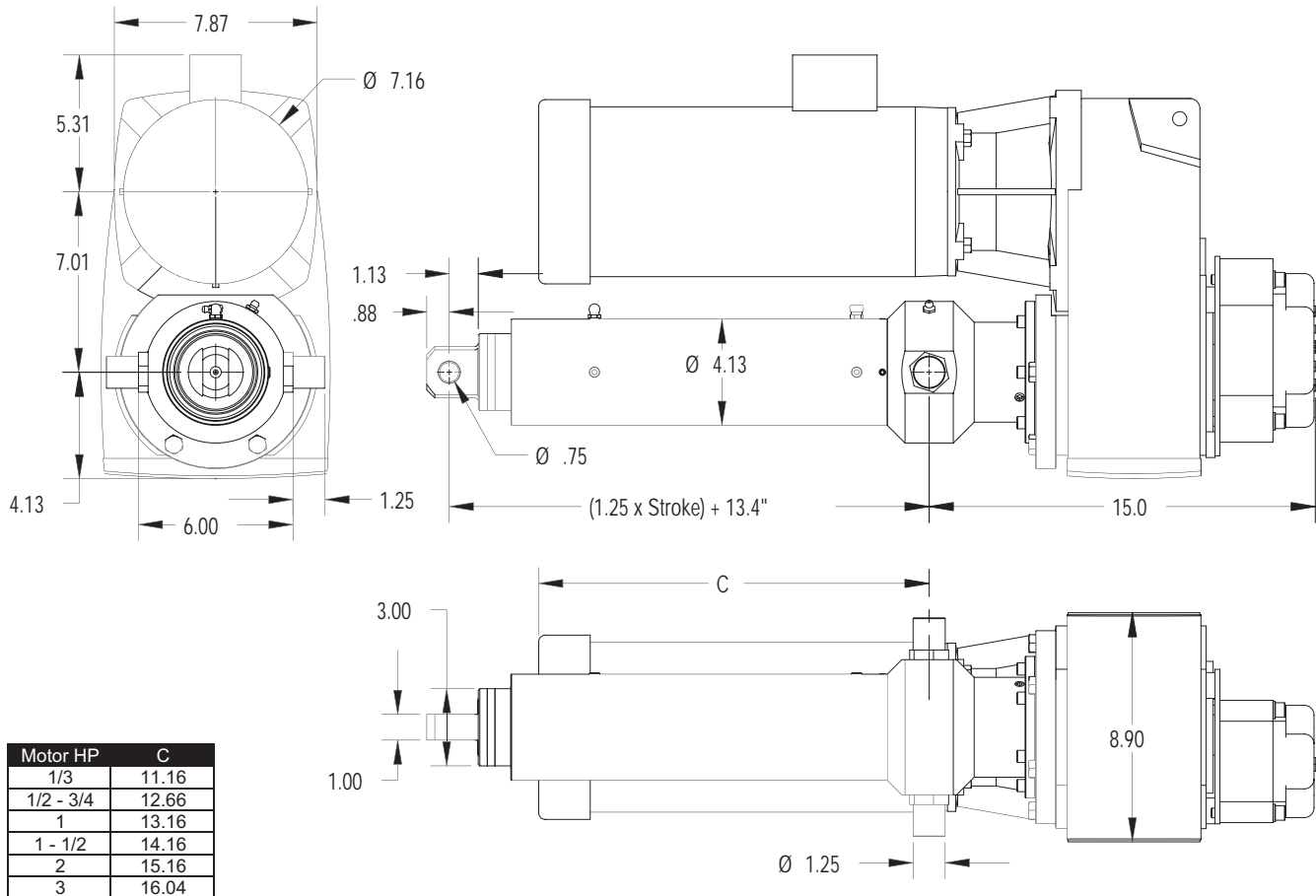

# Product Specifications and Dimensions

## SCN06 Series

Series	Model	Capacity (lbs.)	Speed (in/min)	Std. HP	Max Stroke (inches)	Screw Life (million in.)
SCN06	NLH6-0530*	3281	320.8	3	80.0	12.2
	NLH6-0597*	3695	284.8	3	80.0	8.6
	NLH6-0649*	4017	261.9	3	80.0	6.7
	NLH6-0732*	4531	232.2	3	80.0	4.6
	NLH6-0829*	5131	205.1	3	80.0	3.2
	NLH6-0947*	3908	179.5	2	80.0	7.2
	NL06-0530	6980	152.0	3	73.0	3.0
	NL06-0597	7862	135.0	3	69.0	2.1
	NL06-0649	8547	124.2	3	66.0	1.6
	NL06-0732	9640	110.1	3	62.0	1.1
	NL06-0829	7279	97.2	2	72.0	2.6
	NL06-0947	8315	85.1	2	67.0	1.8
	NL06-1084	9517	74.3	2	63.0	1.2
	NL06-1139	7500	70.7	1.5	71.0	2.4
	NL06-1301	8567	61.9	1.5	66.0	1.6
	NL06-1465	9647	55.0	1.5	62.0	1.1
	NL06-1706	7489	47.2	1*	71.0	2.4
	NL06-1921	8433	41.9	1*	67.0	1.7
	NL06-2195	9636	36.7	1*	62.0	1.1
	NL06-2433	8011	33.1	0.75	68.0	2.0
	NL06-2741	9025	29.4	0.75	64.0	1.4
	NL06-3132	10312	25.7	0.75	60	0.9
	NL06-3380	11129	23.8	0.75	58	0.7
	NL06-3862	8477	20.9	0.5	66	1.7
	NL06-4352	9553	18.5	0.5	62	1.2
	NL06-4973	10916	16.2	0.5	58	0.8
	NL06-5500	12000	14.7	0.5	56	0.6
	NL06-6285	9105	12.8	0.33	64	1.3

Horsepowers with asterisks are NEMA C-face motors.



3 HP Motor shown

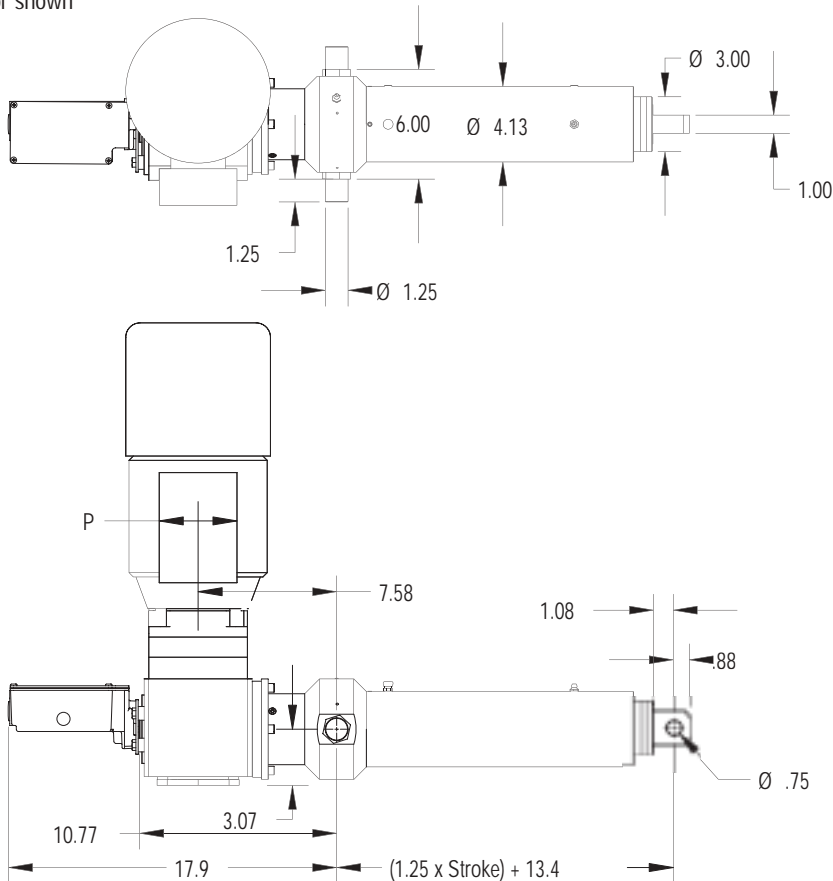

Motor HP	C	FP	AB	TB	N	P
.16 - .25	15.79	5.17	4.84	6.47	5.2	3.43
.33 - .50	16.73	5.71	5.24	7.3	5.2	3.43
.75 - 1.0	17.83	6.5	5.63	7.58	6.02	4.25
1.5 - 2.0	20.43	7.2	5.83	7.77	6.02	4.25
3.0 - 5.0	22.24	7.91	6.26	8.01	6.02	4.25

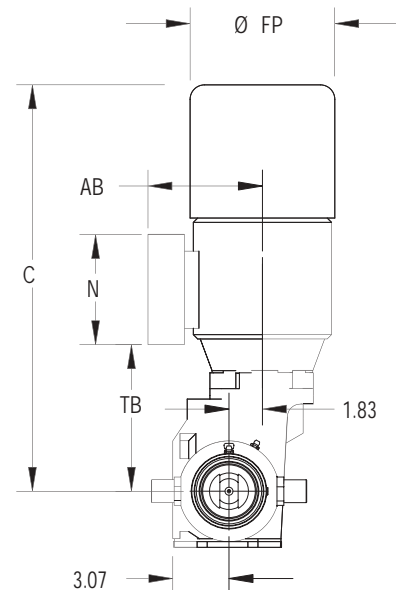

Important: See page 9 for mounting position code.