

Specifications

Maximum Capacity	25 Tons
Maximum Speed	259.7 in/min
Temperature Range	-15° to 140° F (-29° to 60° C)
Construction	Steel trunnion housing, and thin dense nodular chrome plated translating tubes. The translating tubes feature hydraulic cylinder grade wiper seals, and are guided at both ends by polymeric bearings.
Power	Standard brake motors use Class F insulation with Class B rise (1.15 S.F.) All brake motors are totally enclosed, fan cooled. IP66 or wash-down motors are available. Standard brake motors are UL, CSA, or CE marked, depending on voltage. Heidenhain Incremental Motor Encoder option available.
Mounting	Trunnion
Load Screw	3.0 x .666 Ball Screw
Limit Switches	Independently adjustable. Traveling nut style for best repeatability and setting ease. CAM type limits switches are used on Parallel configurations.

Product Specifications and Dimensions

SCN25 Series

Series	Model	Capacity (lbs.)	Speed (in/min)	Std. HP	Max Stroke (inches)	Screw Life (million in.)
SCN25	NZ25-0448	14005	250.4	10	161.0	31.7
	NZ25-0568	17757	197.5	10	161.0	15.5
	NZ25-0670	20945	167.5	10	161.0	9.5
	NZ25-0831	25979	135.0	10	161.0	5.0
	NZ25-0980	30637	114.5	10	161.0	3.0
	NZ25-1138	26682	98.6	7.5	161.0	4.6
	NZ25-1411	33083	79.5	7.5	160.0	2.4
	NZ25-1667	26057	67.3	5	161.0	4.9
	NZ25-2018	31543	55.6	5	161.0	2.8
	NZ25-2138	33419	52.5	5	159.0	2.3
	NZ25-2245	35091	50.0	5	155.0	2.0
	NZ25-2371	22236	47.3	3	161.0	7.9
	NZ25-2588	24272	43.4	3	161.0	6.1
	NZ25-2870	26916	39.1	3	161.0	4.5
	NZ25-3193	29946	35.1	3	161.0	3.2
	NZ25-3777	35423	29.7	3	154.0	2.0
	NZ25-4202	39409	26.7	3	146.0	1.4
	NZ25-4485	42063	25.0	3	142.0	1.2
	NZ25-5297	49678	21.2	3	130.0	0.7
	NZ25-6412	40090	17.5	2	145.0	1.4
	NZ25-6589	41197	17.0	2	143.0	1.2
	NZ25-7976	49869	14.1	2	130	0.7
	NZ25-8874	50000	12.6	2	123	0.7
	NZ25-10088	47305	11.1	1.5	133	0.8
	NZ25-11223	50000	10.0	1.5	127	0.7
	NZ25-12693	39681	8.8	1	146	1.4
	NZ25-16146	50000	6.9	1	129	0.7
	NZ25-19069	44710	5.9	0.75	137	1.0
	NZ25-23083	50000	4.9	0.75	125	0.7
	NZ25-28714	44883	3.9	0.5	137	1.0
	NZ25-40858	42151	2.7	0.33	141	1.2
	NZ25-48256	49783	2.3	0.33	130	0.7

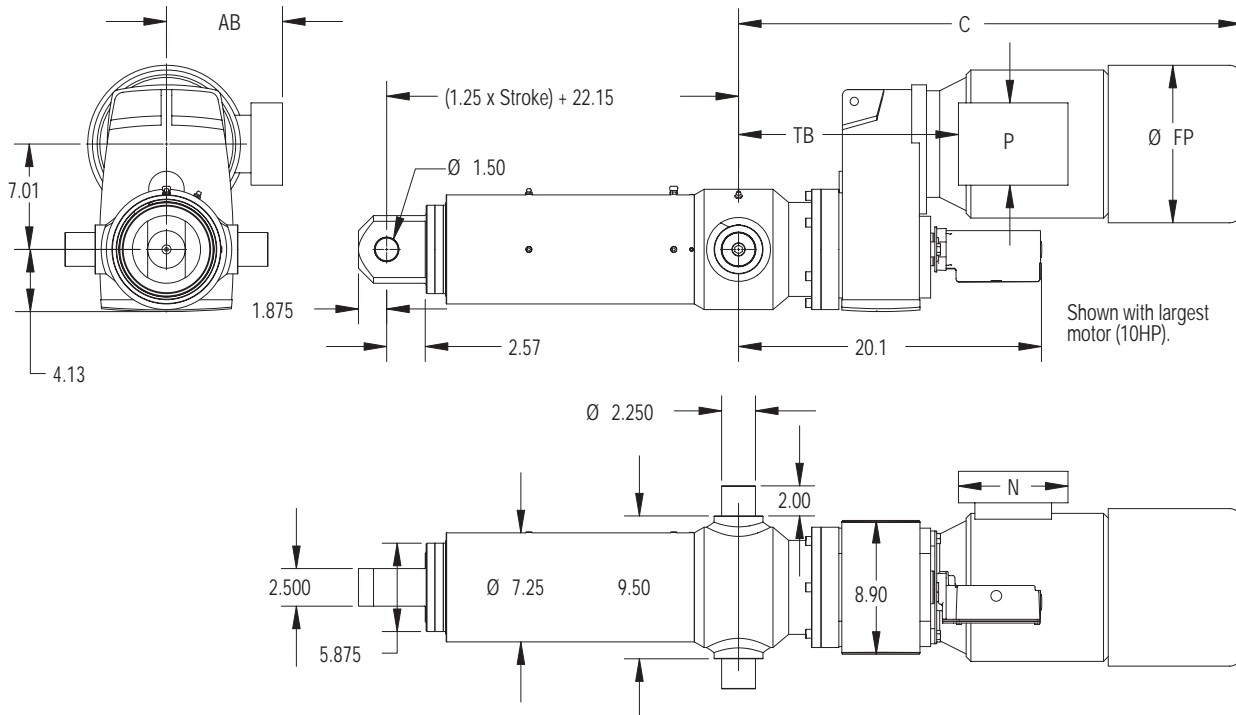

Motor HP	C	FP	AB	TB	N	P
.33 - .50	23.19	5.71	5.24	14.05	5.2	3.43
.75 - 1.0	24.41	6.5	5.63	14.13	6.02	4.25
1.5 - 2.0	26.45	7.2	5.83	14.33	6.02	4.25
3.0 - 5.0	28.27	7.91	6.26	14.57	6.02	4.25
7.5 - 10	33.19	10.47	7.72	14.37	7.28	5.47

Important: See page 9 for mounting position code.



Series	Model	Capacity (lbs.)	Speed (in/min)	Std. HP	Max Stroke (inches)	Screw Life (million in.)
SCN25	NU25-0432	13505	259.7	10	161.0	35.3
	NU25-0501	15662	224.0	10	161.0	22.7
	NU25-0529	16537	212.1	10	161.0	19.2
	NU25-0571	17850	196.5	10	161.0	15.3
	NU25-0633	19789	177.3	10	161.0	11.2
	NU25-0717	22415	156.5	10	161.0	7.7
	NU25-0870	27198	129.0	10	161.0	4.3
	NU25-0946	29574	118.6	10	161.0	3.4
	NU25-1071	33481	104.8	10	159.0	2.3
	NU25-1300	40640	86.3	10	144.0	1.3
	NU25-1538	36060	73.0	7.5	153.0	1.9
	NU25-1759	41242	63.8	7.5	143.0	1.2
	NU25-1888	44267	59.4	7.5	138.0	1.0
	NU25-2036	31824	55.1	5	161.0	2.7
	NU25-2500	39077	44.9	5	147.0	1.5
	NU25-3050	28605	36.8	3	161.0	3.7
	NU25-3343	31352	33.6	3	161.0	2.8
	NU25-3546	33256	31.6	3	159.0	2.4
	NU25-4080	38264	27.5	3	148.0	1.6
	NU25-5555	50000	20.2	3	127.0	0.7
	NU25-8161	50000	13.7	2	129.0	0.7
	NU25-10019	46982	11.2	1.5	134	0.8
	NU25-13403	41900	8.4	1	142	1.2

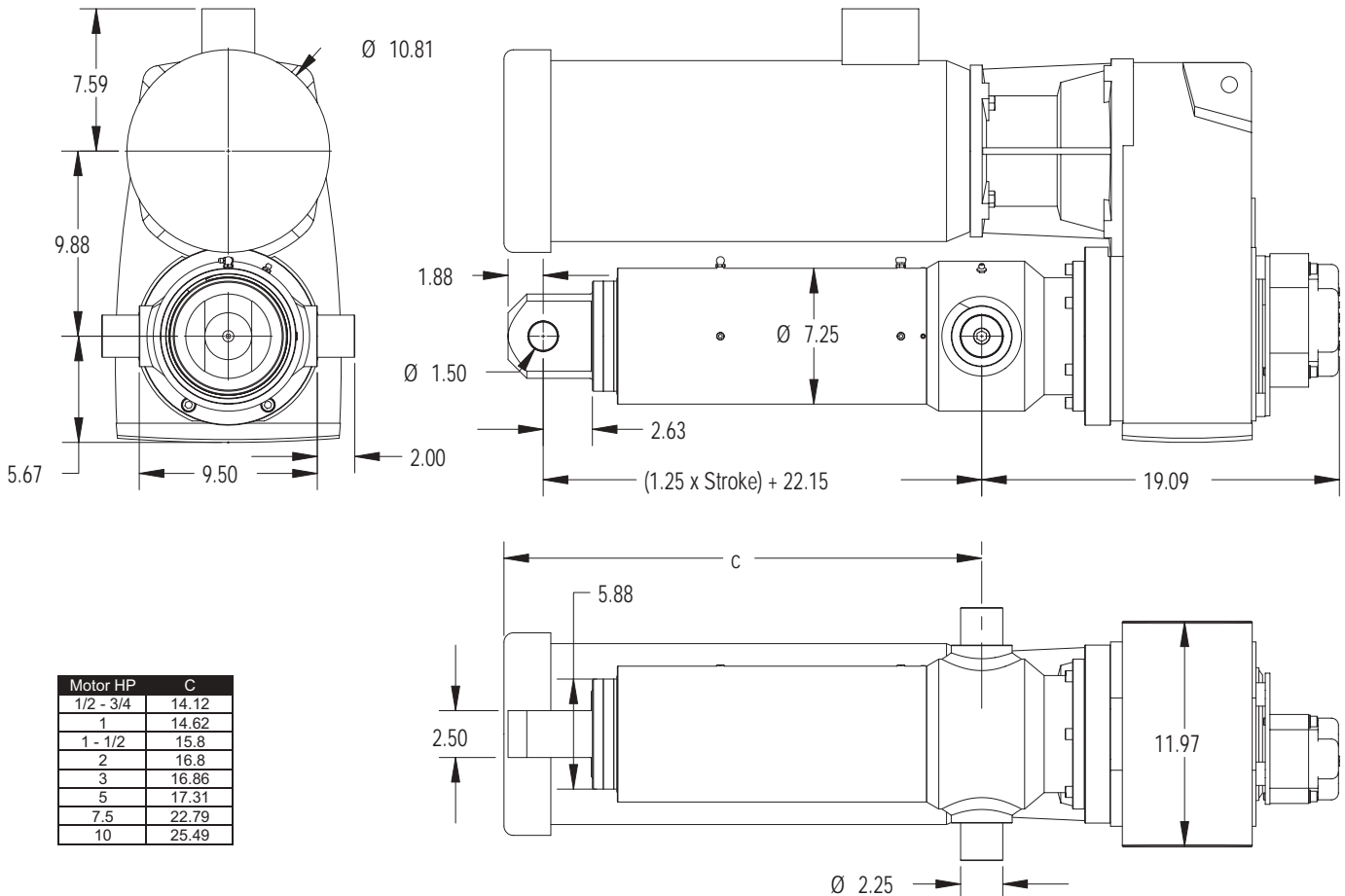

Motor HP	C
1/2 - 3/4	14.12
1	14.62
1 - 1/2	15.8
2	16.8
3	16.86
5	17.31
7.5	22.79
10	25.49

Important: See page 9 for mounting position code.

For additional assistance, contact our Application Engineers at (800) 477-5002.

Product Specifications and Dimensions

Series	Model	Capacity (lbs.)	Speed (in/min)	Std. HP	Max Stroke (inches)	Screw Life (million in.)
SCN25	NL25-0848	26510	132.3	10	161.0	4.7
	NL25-1073	33544	104.6	10	159.0	2.3
	NL25-1268	39640	88.5	10	146.0	1.4
	NL25-1349	42172	83.2	10	141.0	1.2
	NL25-1573	49175	71.3	10	131.0	0.7
	NL25-1708	40046	65.7	7.5	145.0	1.4
	NL25-2023	31621	55.5	5	161.0	2.8
	NL25-2391	37373	46.9	5	150.0	1.7
	NL25-2503	39124	44.8	5	147.0	1.5
	NL25-2966	46361	37.8	5	135.0	0.9
	NL25-3561	33397	31.5	3	159.0	2.3
	NL25-3805	35685	29.5	3	154.0	1.9
	NL25-4036	37852	27.8	3	149.0	1.6
	NL25-4770	44736	23.5	3	137.0	1.0
	NL25-4994	46836	22.5	3	134.0	0.8
	NL25-5917	50000	19.0	3	123.0	0.7
	NL25-6408	40065	17.5	2	145.0	1.4
	NL25-7591	47462	14.8	2	133.0	0.8
	NL25-8417	50000	13.3	2	127.0	0.7
	NL25-9350	50000	12.0	2	120.0	0.7
	NL25-11077	50000	10.1	1.5	127.0	0.7
	NL25-11770	50000	9.5	1.5*	124	0.7
	NL25-13944	43591	8.0	1*	139	1.1
	NL25-15874	49625	7.1	1*	130	0.7
	NL25-18806	50000	6.0	1*	120	0.7
	NL25-19745	46295	5.7	0.75	135	0.9
	NL25-23392	50000	4.8	0.75	124	0.7
	NL25-24972	50000	4.5	0.75	120	0.7
NL25-29585	46244	3.8	0.5	135	0.9	

Horsepowers with asterisks are NEMA C-face motors.

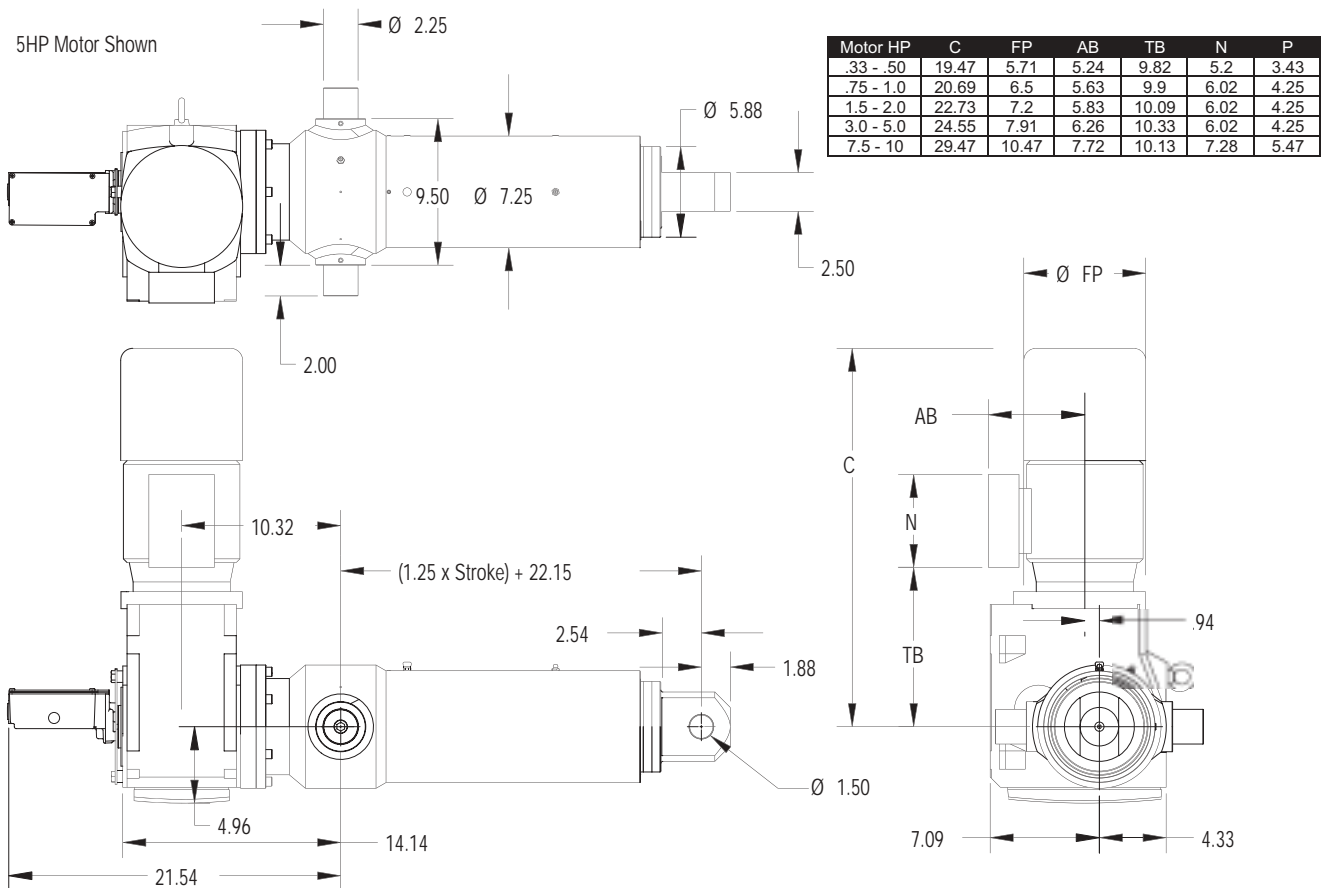

Important: See page 9 for mounting position code.