

### Specifications

<b>Maximum Capacity</b>	2-3 Tons
<b>Maximum Speed</b>	119 in/min
<b>Temperature Range</b>	-20° to 120° F (-29° to 50° C)
<b>Construction</b>	Ductile iron actuator housing, and thin dense nodular chrome plated translating tubes. The translating tubes feature hydraulic cylinder grade wiper seals and are guided at both ends by polymeric bearings.
<b>Power</b>	Brake motor
<b>Mounting</b>	Double clevis
<b>Load Screw</b>	ACME or ball screw
<b>Limit Switches</b>	Independently adjustable

Series	Model	Capacity (lbs.)	Speed (in/min)	HP (1725)	Max Stroke (inches)	Screw Life (million in.)	Dia x Lead (inches)	Screw Type	Configuration
SCW02	W0206A25	2360	72	2	51.6	N/A	1.00 x .25	Acme	Right Angle
	W0206B25	3280	72	1	58.4	1.0	1.00 x .25	Ball	Right Angle
	W0212A25	1300	36	3/4*	51.6	N/A	1.00 x .25	Acme	Right Angle
	W0212B25	4000	36	3/4	52.9	0.52	1.00 x .25	Ball	Right Angle
	W0224B25	3500	18	1/2	56.5	0.78	1.00 x .25	Ball	Right Angle
SCW03	W0306B41	4300	119	2	54.7	0.74	1.17 x .41	Ball	Right Angle
	R0330B01	3600	57.5	1	55.7	0.21	1.00 x 1.00	Ball	Parallel
	R0345B01	3040	38.3	1/2	59.4	0.35	1.00 x 1.00	Ball	Parallel
	R0360B01	3480	28.8	1/2	56.7	0.23	1.00 x 1.00	Ball	Parallel
	R0330B41	6000	23.8	3/4	46.3	0.27	1.17 x .41	Ball	Parallel
	R0345B41	4700	15.8	1/3	52.3	0.57	1.17 x .41	Ball	Parallel
	R0330A25	5330	14.4	1	34.6	N/A	1.00 x .25	Acme	Parallel
	R0360B41	5600	11.9	1/3	47.9	0.34	1.17 x .41	Ball	Parallel
	R0360A25	5100	7.2	1/2*	35.4	N/A	1.00 x .25	Acme	Parallel
	R03120A25	5300	3.6	1/3*	34.7	N/A	1.00 x .25	Acme	Parallel

Models with asterisk by motor HP (1725) are inherently load holding. Motor brake may be omitted if slight drift is acceptable.

# Product Dimensions

## SCW02 & SCW03 Series

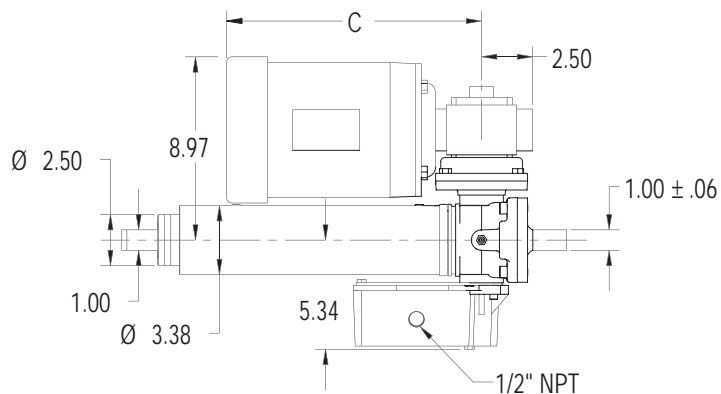

Standard orientations shown.  
Reducer, motor, and limit switch  
can be rotated 90° increments.

Model	A	C
R0330B01	15.25 + (1.25xStroke)	16.73
R0345B01	15.25 + (1.25xStroke)	16.23
R0360B01	15.25 + (1.25xStroke)	16.23
R0330B41	15.25 + (1.25xStroke)	16.23
R0345B41	15.25 + (1.25xStroke)	14.73
R0330A25	14.25 + (1.25xStroke)	16.73
R0360B41	15.25 + (1.25xStroke)	14.73
R0360A25	14.25 + (1.25xStroke)	16.23
R03120A25	14.25 + (1.25xStroke)	14.73

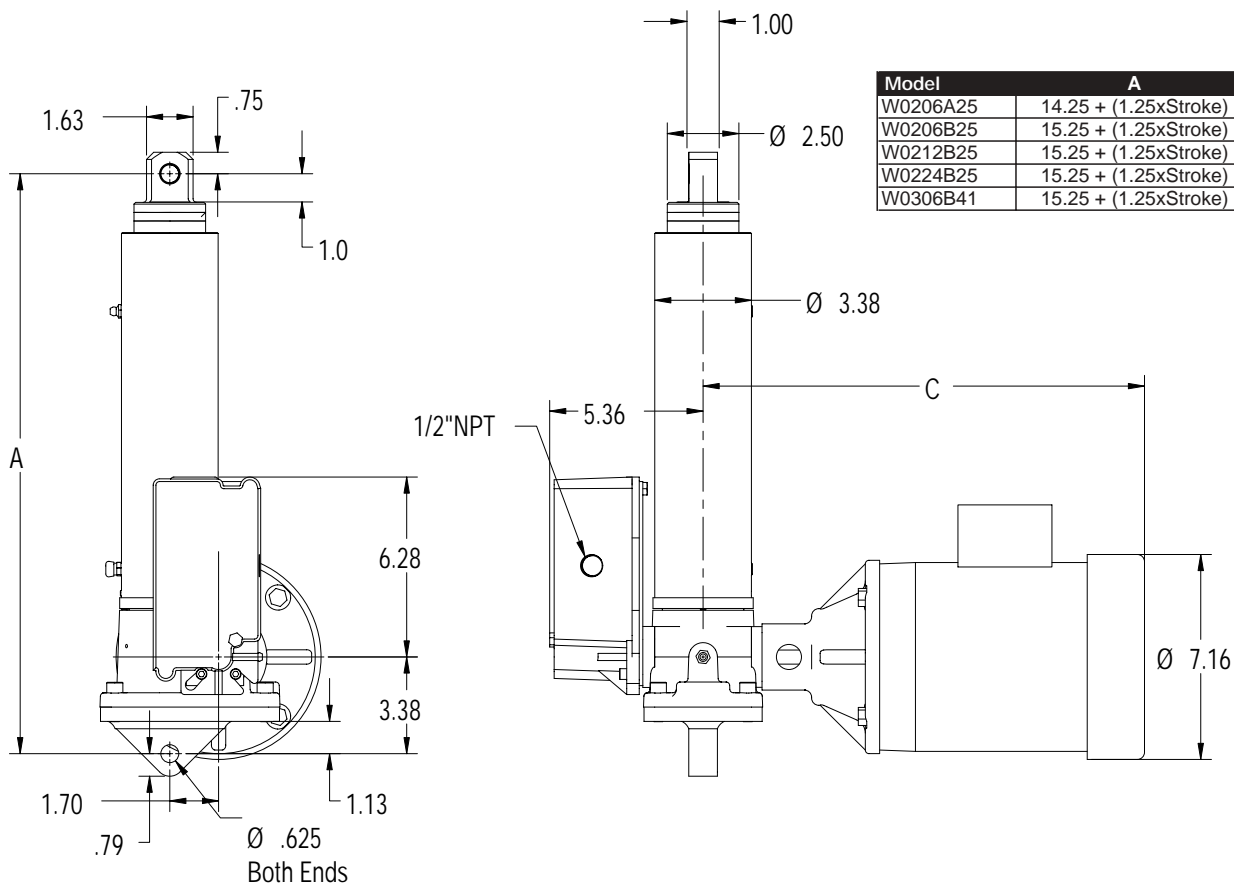
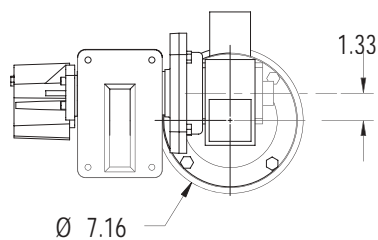
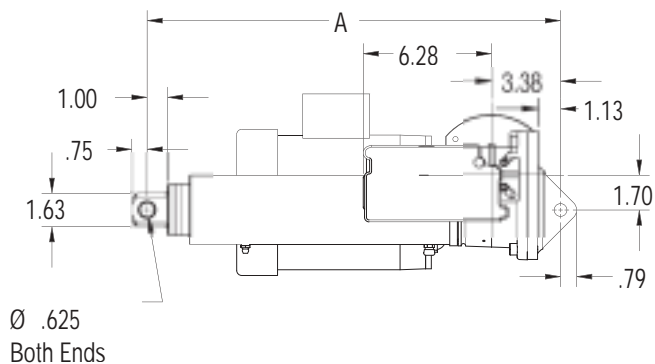

Model	A	C
W0206A25	14.25 + (1.25xStroke)	22.1
W0206B25	15.25 + (1.25xStroke)	19.7
W0212B25	15.25 + (1.25xStroke)	19.2
W0224B25	15.25 + (1.25xStroke)	19.2
W0306B41	15.25 + (1.25xStroke)	22.1