



Specifications

Maximum Capacity	25 Tons
Maximum Speed	26.7 in/min
Temperature Range	-20° to 120° F (-29° to 50° C)
Construction	Ductile iron actuator housing, and thin dense nodular chrome plated translating tubes. The translating tubes feature hydraulic cylinder grade wiper seals, and are guided at both ends by polymeric bearings.
Power	Brake motor
Mounting	Double clevis
Load Screw	ACME or ball screw
Limit Switches	Independently adjustable

Series	Model	Capacity (lbs.)	Speed (in/min)	HP (1725)	Max Stroke (inches)	Screw Life (million in.)	Dia x Lead (inches)	Screw Type	Configuration
SCW25	R2544B66	40700	26.7	5	144.4	1.2	3 x .660	Ball	Parallel
	R2555B66	50000	21.4	5	130.3	0.70	3 x .660	Ball	Parallel
	R2580B66	45000	14.2	3	137.4	0.95	3 x .660	Ball	Parallel
	R25110B66	40000	10.7	2	145.7	1.3	3 x .660	Ball	Parallel
	R25110A66	46000	10.7	7-1/2*	143.4	N/A	3 x .666	Acme	Parallel
	R25220B66	50000	5.3	1.5	130.3	0.70	3 x .660	Ball	Parallel
	R25220A66	44500	5.3	5*	145.8	N/A	3 x .666	Acme	Parallel
	R25440B66	48000	2.7	3/4	133.0	0.78	3 x .660	Ball	Parallel
	R25440A66	40400	2.7	2*	153.0	N/A	3 x .666	Acme	Parallel

Models with asterisk by motor HP (1725) are inherently load holding. Motor brake may be omitted if slight drift is acceptable.

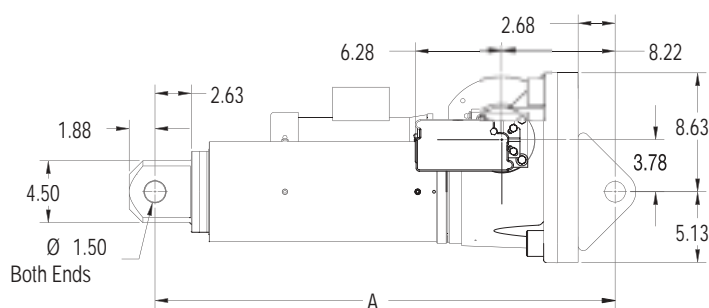
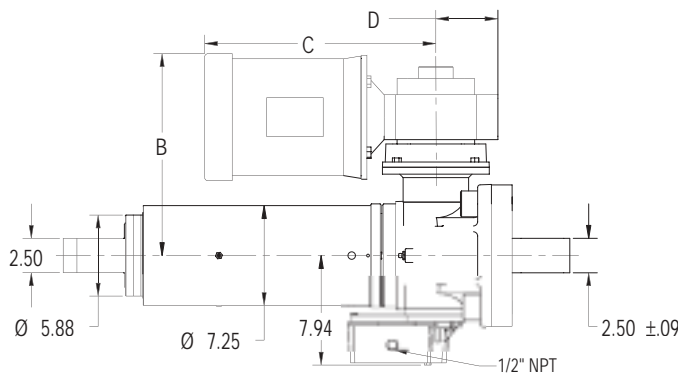

Standard orientations shown. Reducer, motor, and limit switch can be rotated 90° increments.

Model	A	B	C	D	E	F
R2543B66	32.12 + (1.25xStroke)	14.65	21.69	4.50	9.22	2.63
R2555B66	32.12 + (1.25xStroke)	14.65	21.69	5.46	9.22	3.50
R2580B66	32.12 + (1.25xStroke)	14.65	21.24	4.50	9.22	2.63
R25110B66	32.12 + (1.25xStroke)	14.65	21.24	4.50	9.22	2.63
R25110A66	29.12 + (1.25xStroke)	15.49	27.60	6.28	9.22	4.25
R25220B66	32.12 + (1.25xStroke)	13.62	20.26	4.50	7.16	2.63
R25220A66	29.12 + (1.25xStroke)	15.49	22.12	5.46	9.22	3.50
R25440B66	32.12 + (1.25xStroke)	13.62	18.88	4.50	7.16	2.63
R25440A66	29.12 + (1.25xStroke)	14.46	21.69	5.46	7.16	3.50

